

HydroClaw™

superior clog-resistant nozzle for ferocious tank cleaning

- Triple the free passage of spray balls
- Unique, patent-pending, clog-resistant design with no moving parts
- Complete 360° coverage
- Vigorous rinsing action quickly flushes solids and contamination from vessels.

Who needs the HydroClaw?

- Wineries: spray balls get clogged with stems, skins, and seeds
- Breweries: spray balls get clogged with grains and hops

Advantages of the HydroClaw

Low-maintenance design

- Self-draining and self-flushing design
- No moving parts = low maintenance

High-precision machining

- 316L stainless steel construction for food-grade and sanitary applications.
- Laser-welded for durability

Designed with your tank in mind

- Available connections: 1" Female NPT or G threads, 1.5" or DN40 tube clip-on, 1" pipe clip-on
- Fits through 3" diameter opening
- Spray angle: complete 360° coverage for tanks up to 10' in diameter
- Free passage: allows passage of particles over 1/4" in diameter; three times the free passage of a comparable spray ball

Flow rates:

Clip-on flow rate: 100 gpm
Threaded flow rate: 90 gpm

- **Recommended operating pressure:** 30 psi
- Low pressure, high flow for quick, energy-efficient rinse

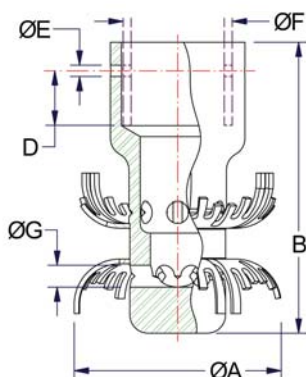

Dimensions (in.)	
A	2.88
B	4.00
D	0.75
E	0.16
F	1.50
G	0.30



Fermentation tank cleaned with the HydroClaw



BETE®

BETE Fog Nozzle, Inc.
50 Greenfield St.
Greenfield, MA 01301
T (413) 772-0846
www.bete.com

Call for the name of your nearest BETE representative.

CALL 413-772-0846